

PLANTING LEGEND (SEE MOUNT VERNON'S APPROVED TREE LIST FOR ADDITIONAL OPTIONS)

Symbol	Scientific Name	Common Name	Planting Size	Quantity
Broadleaf Deciduous				
Listed species are a sampling only				
	Acer palmatum 'Atropurpurea'	Red Japanese maple	2"-Cal	QUANTITIES TO BE LISTED
	Amelanchier grandiflora 'Autumn Brilliance'	Serviceberry	2"-Cal	
	Cercis canadensis 'Forest Pansy'	Forest Pansy Redbud	2"-Cal	
	Cornus Sp. 'Eddie's White Wonder'	Ornamental Dogwood	2"-Cal	
	Chamaecyparis nootkatensis 'Green Arrow'	Weeping Alaska Cedar	8' - 10'	

Symbol	Scientific Name	Common Name	Planting Size	Quantity
Perennials, Grasses and Ferns				
Listed species are a sampling only				
	Polystichum munitum	Sword Fern	1-Gal	QUANTITIES TO BE LISTED
	Carex morrowii variegata	Morrow's Sedge	1-Gal	
	Helictotrichon sempervirens	Blue Oat Grass	1-Gal	
	Miscanthus sinensis 'Little Kitten'	Dwarf Maiden Grass	1-Gal	
	Calluna vulgaris	Scotch heather	1-Gal	
	Hemerocallis 'Stella de Oro'	Daylily	1-Gal	
	Liriope muscari	Big blue lily turf	1-Gal	
	Rudbeckia fulgida var. sullivantii	Dwarf Black Eyed Susan	1-Gal	
	Sedum telephium 'Autumn Joy'	Autumn Joy Sedum	1-Gal	

Symbol	Scientific Name	Common Name	Planting Size	Quantity
Shrub				
Listed species are a sampling only				
	Berberis thunbergii 'Crimson Pygmy'	Crimson Pygmy	2-Gal	QUANTITIES TO BE LISTED
	Buxus microphylla japonica 'compacta'	Dwarf Boxwood	2-Gal	
	Cornus stolonifera 'Kelsey'	Dwarf Redtwig Dogwood	2-Gal	
	Cornus stolonifera 'Flaviramea'	Golden twig dogwood	2-Gal	
	Euonymus alatus 'Compactus'	Dwarf Burning Bush	2-Gal	
	Gaultheria shallon	Salal	2-Gal	
	Hydrangea macrophylla 'Bailmer'	'Endless Summer'	2-gal	
	Physocarpus opulifolius 'Nanus'	Little Devil Ninebark	2-Gal	
	Pieris japonica 'Bisbee Dwarf'	Bisbee Dwarf Pieris	2-Gal	
	Prunus Laurocerasus 'Otto Luyken'	Otto Luyken Laurel	2-Gal	
	Rhododendron 'PJM'	PJM Rhody	2-Gal	
	Rhododendron 'Ramapo'	Ramapo Rhod.	2-Gal	
	Sarcococca humilis	Himalayan sarcococca	2-Gal	
	Spirea japonica 'Little Princess'	Little Princess Spirea	2-Gal	
	Syringa patula 'Miss Kim'	Miss Kim Lilac	2-Gal	
	Viburnum davidii	David's Viburnum	2-Gal	

Symbol	Scientific Name	Common Name	Planting Size	Quantity
Ground Cover				
Listed species are a sampling only				
	Arcostaphylos uva-ursi	Kinnikinnick	1-Gal	QUANTITIES TO BE LISTED
	Fragaria chiloensis	Beach Strawberry	1-Gal	
	Rubus calycinoides	Creeping Bramble	1-Gal	
	n/a	Lawn Grass		

PLANTING PLAN
1" = 30'-0" (CHECK SCALE BAR FOR ACCURACY)

Landscape Requirements and Formulas		
	S.F.	
GROSS SQUARE FOOTAGE	(GSF)	
Landscape Area Required (10%)	0.10x(GSF)	
Landscape Area Provided	Must be equal to or greater than the value above	actual %
PARKING LOT AREA	(PLA)	
Landscape Area Required (4%)	0.04x(PLA)	
Parking Lot Landscape Area Provided	Must be equal to or greater than the value above	actual %
Number of Trees Required	1 per every 150 SF	
Number of Trees Provided	actual # of trees	

- GENERAL NOTES** APPLICABLE NOTES FROM LANDSCAPE DETAIL 11A/B NEED TO BE PLACED ON THE SITE PLAN
- ALL WORK SHALL BE PERFORMED BY PERSONS FAMILIAR WITH THIS KIND OF WORK AND UNDER THE SUPERVISION OF A QUALIFIED FOREMAN.
 - ALL PLANT MATERIAL SIZES AND QUALITY TO CONFORM TO AMERICAN ASSOC. OF NURSERYMEN, AMERICAN STANDARD FOR NURSERY STOCK, 2002.
 - PLANT LOCATIONS ON THE PLANS ARE DIAGRAMMATIC AND MAY BE SUBJECT TO ADJUSTMENT IN THE FIELD BY THE LANDSCAPE CONTRACTOR.
 - ALL PLANT MATERIAL SHALL BE OF NURSERY STOCK AND SHALL BE OF THE TYPE, SIZE AND CONDITION SPECIFIED. THE PLANT MATERIAL SHALL EXHIBIT NORMAL HABITS OF GROWTH FOR THE SPECIES, SHALL HAVE BUDS INTACT AND SHALL BE FREE OF DISEASE, INSECTS, SCARS, BRUISES, BREAKS, SEED AND WEED ROOTS.
 - FINE BARK MULCH IS TO BE INSTALLED AT ALL NEW PLANTING AREAS WITH A MINIMUM OF 2 INCHES.
 - LANDSCAPE CONTRACTOR SHALL VERIFY LOCATION OF ALL SITE UTILITIES PRIOR TO LANDSCAPE IMPLEMENTATION. PLANT LOCATIONS MAY BE ADJUSTED TO AVOID CONFLICT.
 - LANDSCAPE CONTRACTOR SHALL TAKE NECESSARY PRECAUTIONS TO PROTECT EXISTING SITE IMPROVEMENTS, PAVING, WALLS, AND UNDERGROUND UTILITIES. DAMAGE SHALL BE REPAIRED TO THE OWNER'S SATISFACTION AND AT NO ADDITIONAL COST.
 - PLANT COUNT IS FOR THE CONTRACTOR'S CONVENIENCE; IF THERE IS A DISCREPANCY, THE PLAN SHALL GOVERN. ACTUAL PLANT QUANTITIES TO BE DETERMINED BY REQUIRED PLANT SPACING.
 - ALL AREAS TO BE PLANTED WITH GROUND COVER ARE INDICATED ON THE PLAN WITH A HATCH PATTERN. SEE PLANT LIST FOR PLANT TYPE, SIZE, AND SPACING.
 - ALL AREAS TO BE PLANTED WITH SEED MAY BE PLANTED WITH LOCALLY PROVEN SOD WHEN SEASONS OR CONDITIONS PREVENT SUCCESSFUL GERMINATION.
 - SUBSTITUTION OF PLANT VARIETIES DUE TO LACK OF AVAILABILITY SUBJECT TO APPROVAL BY THE CITY OF MOUNT VERNON.
 - ALL DIMENSIONS ARE ASSUMED TO BE PARALLEL OR PERPENDICULAR UNLESS OTHERWISE NOTED.
 - ALL SOIL GRADES TO BE A MINIMUM SIX INCHES BELOW ADJACENT FINISH FLOOR ELEVATIONS UNLESS NOTED OTHERWISE. ALL GRADES ADJACENT TO A BUILDING SHALL HAVE A MAXIMUM SLOPE OF 5% 3 FROM FOUNDATION.
 - ALL GRADES, DIMENSIONS AND EXISTING CONDITIONS SHALL BE VERIFIED BY THE CONTRACTOR PRIOR TO CONSTRUCTION. ANY DISCREPANCIES SHALL BE BROUGHT TO THE ATTENTION OF THE LANDSCAPE ARCHITECT.
 - PLANTING PLAN EMPHASIZES DROUGHT TOLERANT AND NATIVE PLANTS TO BE USED IN AN AMENDED SOIL IN LIEU OF AN AUTOMATED IRRIGATION SYSTEM AS A WATER CONSERVATION BEST PRACTICE. SUPPLEMENTAL HAND WATERING WILL BE DONE DURING FIRST TWO YEARS TO GUARANTEE PLANT ESTABLISHMENT.

- SOIL NOTES** APPLICABLE NOTES FROM LANDSCAPE DETAIL 11A/B NEED TO BE PLACED ON THE SITE PLAN
- CONTRACTOR MAY STOCKPILE SITE TOPSOIL FOR POSSIBLE RE-USE IN LANDSCAPE BEDS. STOCKPILED TOPSOIL TO BE TESTED BY A SOILS LABORATORY FOR NURSERY OR AGRICULTURAL USE AND RECOMMENDATIONS FOR AMENDMENTS TO BE FOLLOWED.
 - SITE TOPSOIL TO BE SCREENED TO REMOVE ALL GRASS CLODS AND DEBRIS LARGER THAN 1"
 - EXISTING SITE TOPSOIL TO BE AMENDED WITH COMPOST AT A RATIO OF 3:1. 3 UNITS OF EXISTING SOIL TO ONE UNIT OF COMPOST.
 - IN LIEU OF AMENDING SITE TOPSOIL, CONTRACTORS MAY CHOOSE TO USE IMPORTED 3-WAY TOPSOIL.
 - TOPSOIL DEPTHS
 - TOPSOIL TO BE PLACED AT A MINIMUM OF 6" IN ALL LANDSCAPE BED AREAS AND INCORPORATED INTO EXISTING SUBGRADE.
 - TOPSOIL TO BE PLACED AT AT MINIMUM OF 12" IN ALL TREE-PIT AREAS.
 - LAWN / GRASS AREA HAVE A MINIMUM 2" PROFILE OF TOPSOIL.
 - IN ALL INSTANCES, PLACED TOPSOIL TO BE INCORPORATED INTO EXISTING GRADE.

CITY LANDSCAPE SIGNATURE BLOCK, DETAIL NO. 10, SHALL BE PLACED ON SITE PLANS

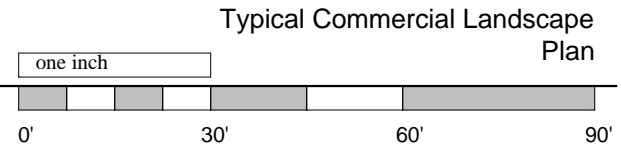

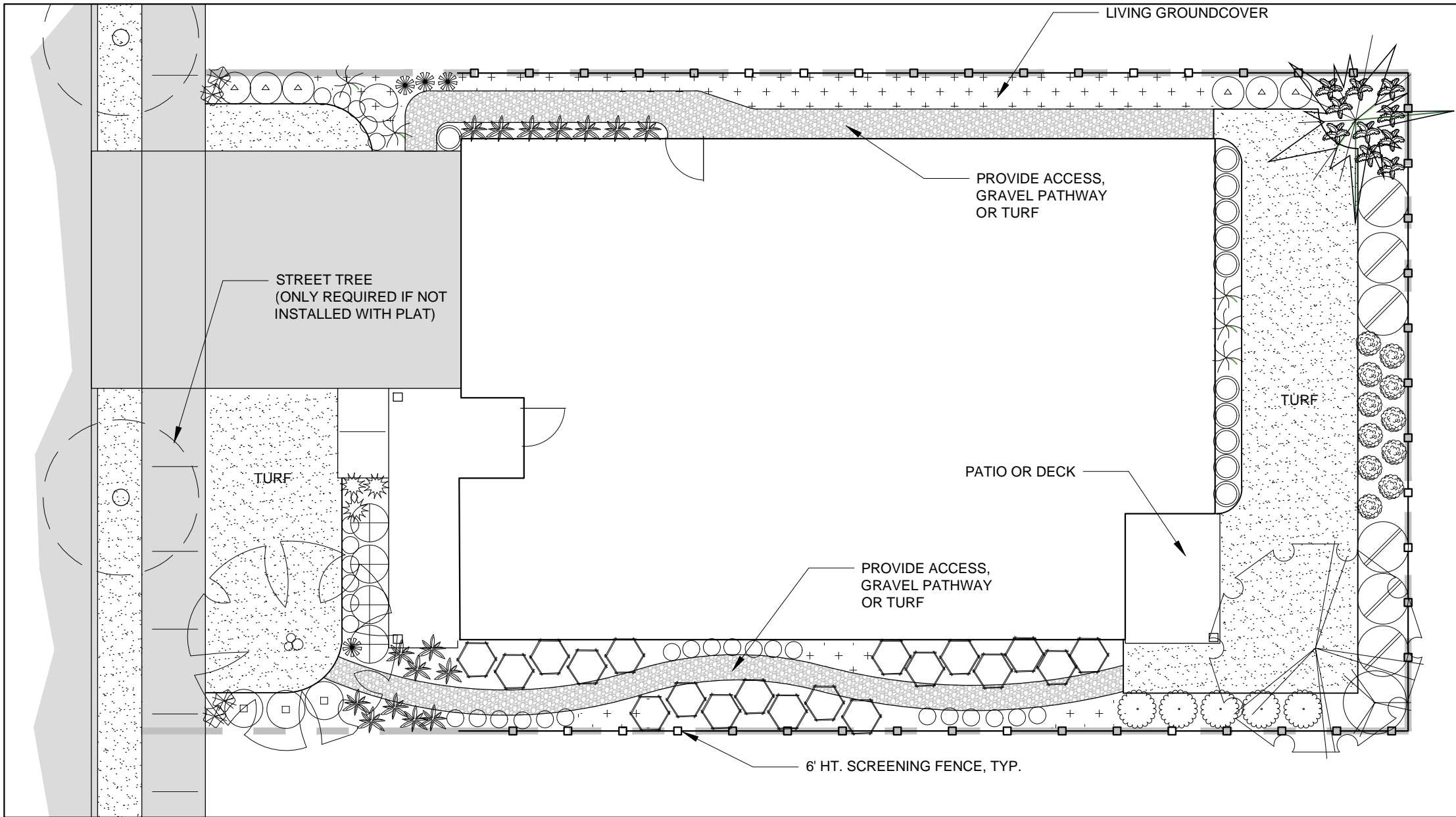

PLANTING LEGEND (SEE MOUNT VERNON'S APPROVED TREE LIST FOR ADDITIONAL OPTIONS)

Broadleaf Deciduous				
Symbol	Quantity	Scientific Name	Common Name	Planting Size
	3	Trees minimum per homeowner lot		
	QUANTITIES TO BE LISTED	Acer palmatum 'Atropurpurea'	Red Japanese maple	2"-Cal
		Amelanchier grandiflora 'Autumn Brilliance'	Serviceberry	2"-Cal
		Cercis canadensis 'Forest Pansy'	Forest Pansy Redbud	2"-Cal
		Cornus Sp. 'Eddies White Wonder'	Ornamental Dogwood	2"-Cal
		Chamaecyparis nootkatensis 'Green Arrow'	Weeping Alaska Cedar	8' - 10'

Perennials, Grasses and Ferns				
Symbol	Quantity	Scientific Name	Common Name	Planting Size
	20	Minimum per homeowner lot		
	QUANTITIES TO BE LISTED	Polystichum munitum	Sword Fern	1-Gal
		Carex morrowii variegata	Morrow's Sedge	1-Gal
		Helictotrichon sempervirens	Blue Oat Grass	1-Gal
		Miscanthus sinensis 'Little Kitten'	Dwarf Maiden Grass	1-Gal
		Calluna vulgaris	Scotch heather	1-Gal
		Hemerocallis 'Stella de Oro'	Daylily	1-Gal
		Liriope muscari	Big blue lily turf	1-Gal
		Rudbeckia fulgida var. sullivantii	Dwarf Black Eyed Susan	1-Gal
		Sedum telephium 'Autumn Joy'	Autumn Joy Sedum	1-Gal

Shrub				
Symbol	Quantity	Scientific Name	Common Name	Planting Size
	70	Minimum per homeowner lot		
	QUANTITIES TO BE LISTED	Berberis thunbergii 'Crimson Pygmy'	Crimson Pygmy	2-Gal
		Buxus microphylla japonica 'compacta'	Dwarf Boxwood	2-Gal
		Cornus stolonifera 'Kelseyi'	Dwarf Redtwig Dogwood	2-Gal
		Cornus stolonifera 'Flaviramea'	Golden twig dogwood	2-Gal
		Euonymus alatus 'Compactus'	Dwarf Burning Bush	2-Gal
		Gaultheria shallon	Saial	2-Gal
		Hydrangea macrophylla 'Bailmer'	'Endless Summer'	2-gal
		Physocarpus opulifolius 'Nanus'	Little Devil Ninebark	2-Gal
		Pieris japonica 'Bisbee Dwarf'	Bisbee Dwarf Pieris	2-Gal
		Prunus Laurocerasus 'Otto Luyken'	Otto Luyken Laurel	2-Gal
		Rhododendron 'PJM'	PJM Rhody	2-Gal
		Rhododendron 'Ramapo'	Ramapo Rhod.	2-Gal
		Sarcococca humilis	Himalayan sarcococca	2-Gal
		Spirea Japonica 'Little Princess'	Little Princess Spirea	2-Gal
		Syringa patula 'Miss Kim'	Miss Kim Lilac	2-Gal
Viburnum davidii	David's Viburnum	2-Gal		

Ground Cover				
Symbol	Quantity	Scientific Name	Common Name	Planting Size
	20	Minimum per homeowner lot		
	QUANTITIES TO BE LISTED	Arcostaphylos uva-ursi	Kinnikinnick	1-Gal
		Fragaria chiloensis	Beach Strawberry	1-Gal
varies	Rubus calycinoides	Creeping Bramble	1-Gal	
	Minimum per homeowner lot	Lawn Grass		
	n/a			

PLANTING PLAN 1" = 10'-0" (CHECK SCALE BAR FOR ACCURACY)

GENERAL NOTES APPLICABLE NOTES FROM LANDSCAPE DETAIL 11A/B NEED TO BE PLACED ON THE SITE PLAN

- ALL WORK SHALL BE PERFORMED BY PERSONS FAMILIAR WITH THIS KIND OF WORK AND UNDER THE SUPERVISION OF A QUALIFIED FOREMAN.
- ALL PLANT MATERIAL SIZES AND QUALITY TO CONFORM TO AMERICAN ASSOC. OF NURSERYMEN, AMERICAN STANDARD FOR NURSERY STOCK, 2002.
- PLANT LOCATIONS ON THE PLANS ARE DIAGRAMMATIC AND MAY BE SUBJECT TO ADJUSTMENT IN THE FIELD BY THE LANDSCAPE CONTRACTOR.
- ALL PLANT MATERIAL SHALL BE OF NURSERY STOCK AND SHALL BE OF THE TYPE, SIZE AND CONDITION SPECIFIED. THE PLANT MATERIAL SHALL EXHIBIT NORMAL HABITS OF GROWTH FOR THE SPECIES, SHALL HAVE BUDS INTACT AND SHALL BE FREE OF DISEASE, INSECTS, SCARS, BRUISES, BREAKS, SEED AND WEED ROOTS.
- ALL LANDSCAPE AREAS SHALL HAVE PLANTING BACKFILL AMENDED WITH A TRANSPILANT AMENDMENT (SUPERTHRIVE OR EQUAL) AND WETTING AGENT (TERAWET OR EQUAL) APPLIED AT MANUFACTURERS RECOMMENDED RATE.
- FINE BARK MULCH IS TO BE INSTALLED AT ALL NEW PLANTING AREAS WITH A MINIMUM OF 2 INCHES.
- LANDSCAPE CONTRACTOR SHALL VERIFY LOCATION OF ALL SITE UTILITIES PRIOR TO LANDSCAPE IMPLEMENTATION. PLANT LOCATIONS MAY BE ADJUSTED TO AVOID CONFLICT.
- LANDSCAPE CONTRACTOR SHALL TAKE NECESSARY PRECAUTIONS TO PROTECT EXISTING SITE IMPROVEMENTS, PAVING, WALLS, AND UNDERGROUND UTILITIES. DAMAGE SHALL BE REPAIRED TO THE OWNER'S SATISFACTION AND AT NO ADDITIONAL COST.
- PLANT COUNT IS FOR THE CONTRACTOR'S CONVENIENCE; IF THERE IS A DISCREPANCY, THE PLAN SHALL GOVERN. ACTUAL PLANT QUANTITIES TO BE DETERMINED BY REQUIRED PLANT SPACING.
- ALL AREAS TO BE PLANTED WITH GROUNDCOVER ARE INDICATED ON THE PLAN WITH A HATCH PATTERN. SEE PLANT LIST FOR PLANT TYPE, SIZE, AND SPACING.
- ALL AREAS TO BE PLANTED WITH SEED MAY BE PLANTED WITH LOCALLY PROVEN SOD WHEN SEASONS OR CONDITIONS PREVENT SUCCESSFUL GERMINATION.
- SUBSTITUTION OF PLANT VARIETIES DUE TO LACK OF AVAILABILITY SUBJECT TO APPROVAL BY THE CITY OF MOUNT VERNON.
- ALL DIMENSIONS ARE ASSUMED TO BE PARALLEL OR PERPENDICULAR UNLESS OTHERWISE NOTED.
- ALL SOIL GRADES TO BE A MINIMUM SIX INCHES BELOW ADJACENT FINISH FLOOR ELEVATIONS UNLESS NOTED OTHERWISE. ALL GRADES ADJACENT TO A BUILDING SHALL HAVE A MAXIMUM SLOPE OF 5% FROM FOUNDATION.
- ALL GRADES, DIMENSIONS AND EXISTING CONDITIONS SHALL BE VERIFIED BY THE CONTRACTOR PRIOR TO CONSTRUCTION. ANY DISCREPANCIES SHALL BE BROUGHT TO THE ATTENTION OF THE LANDSCAPE ARCHITECT.
- PLANTING PLAN EMPHASIZES DROUGHT TOLERANT AND NATIVE PLANTS TO BE USED IN AN AMENDED SOIL IN LIEU OF AN AUTOMATED IRRIGATION SYSTEM AS A WATER CONSERVATION 'BEST PRACTICE'. SUPPLEMENTAL HAND WATERING WILL BE DONE DURING FIRST TWO YEARS TO GUARANTEE PLANT ESTABLISHMENT.
- BASEMAP PROVIDED BY OWNER.

SOIL NOTES APPLICABLE NOTES FROM LANDSCAPE DETAIL 11A/B NEED TO BE PLACED ON THE SITE PLAN

- CONTRACTOR MAY STOCKPILE SITE TOPSOIL FOR POSSIBLE RE-USE IN LANDSCAPE BEDS. STOCKPILED TOPSOIL TO BE TESTED BY A SOILS LABORATORY FOR NURSERY OR AGRICULTURAL USE AND RECOMMENDATIONS FOR AMENDMENTS TO BE FOLLOWED.
- SITE TOPSOIL TO BE SCREENED TO REMOVE ALL GRASS CLODS AND DEBRIS LARGER THAN 1"
- EXISTING SITE TOPSOIL TO BE AMENDED WITH COMPOST AT A RATIO OF 3:1. 3 UNITS OF EXISTING SOIL TO ONE UNIT OF COMPOST.
- IN LIEU OF AMENDING SITE TOPSOIL, CONTRACTORS MAY CHOOSE TO USE IMPORTED 3-WAY TOPSOIL.
- TOPSOIL DEPTHS
 - TOPSOIL TO BE PLACED AT A MINIMUM OF 6" IN ALL LANDSCAPE BED AREAS AND INCORPORATED INTO EXISTING SUBGRADE.
 - TOPSOIL TO BE PLACED AT A MINIMUM OF 12" IN ALL TREE-PIT AREAS.
 - LAWN / GRASS AREA HAVE A MINIMUM 2" PROFILE OF TOPSOIL.
- IN ALL INSTANCES, PLACED TOPSOIL TO BE INCORPORATED INTO EXISTING GRADE.

CITY LANDSCAPE SIGNATURE BLOCK, DETAIL NO. 10, SHALL BE PLACED ON SITE PLANS

Landscape Statistics				
	City Standard	Provided	Total Plant Count (minimum)	MISC.
TREES (2" CALIPER)	3 per unit	3	3	
SHRUBS (2 GAL)	80 per unit	70	90	1. The deficit of 10 shrubs is met with the specification of 20 perennials, ferns and accent grasses for a total plant count of 90.
GROUNDCOVER (1 GAL.)	20 per unit	20	20	

