

SEP 06 2018

C.E.D. DEPARTMENT

WRITTEN
BY Staff
10/27/2018
mma**SEPA ENVIRONMENTAL CHECKLIST*****Purpose of checklist:***

Governmental agencies use this checklist to help determine whether the environmental impacts of your proposal are significant. This information is also helpful to determine if available avoidance, minimization or compensatory mitigation measures will address the probable significant impacts or if an environmental impact statement will be prepared to further analyze the proposal.

Instructions for applicants:

This environmental checklist asks you to describe some basic information about your proposal. Please answer each question accurately and carefully, to the best of your knowledge. You may need to consult with an agency specialist or private consultant for some questions. You may use "not applicable" or "does not apply" only when you can explain why it does not apply and not when the answer is unknown. You may also attach or incorporate by reference additional studies reports. Complete and accurate answers to these questions often avoid delays with the SEPA process as well as later in the decision-making process.

The checklist questions apply to all parts of your proposal, even if you plan to do them over a period of time or on different parcels of land. Attach any additional information that will help describe your proposal or its environmental effects. The agency to which you submit this checklist may ask you to explain your answers or provide additional information reasonably related to determining if there may be significant adverse impact.

Instructions for Lead Agencies:

Please adjust the format of this template as needed. Additional information may be necessary to evaluate the existing environment, all interrelated aspects of the proposal and an analysis of adverse impacts. The checklist is considered the first but not necessarily the only source of information needed to make an adequate threshold determination. Once a threshold determination is made, the lead agency is responsible for the completeness and accuracy of the checklist and other supporting documents.

Use of checklist for nonproject proposals:

For nonproject proposals (such as ordinances, regulations, plans and programs), complete the applicable parts of sections A and B plus the SUPPLEMENTAL SHEET FOR NONPROJECT ACTIONS (part D). Please completely answer all questions that apply and note that the words "project," "applicant," and "property or site" should be read as "proposal," "proponent," and "affected geographic area," respectively. The lead agency may exclude (for non-projects) questions in Part B - Environmental Elements –that do not contribute meaningfully to the analysis of the proposal.

A. Background [HELP]

1. Name of proposed project, if applicable: **New Life Church PL17-085**
2. Name of applicant: **Igor Kaparchuk**

3. Address and phone number of applicant and contact person: **5501B E. Division St. Mt. Vernon, WA 98274, (360) 391-5808**

4. Date checklist prepared: **8/15/2018**

5. Agency requesting checklist: **City of Mount Vernon**

6. Proposed timing or schedule (including phasing, if applicable): **Fall 2018 - Spring 2019**

7. Do you have any plans for future additions, expansion, or further activity related to or connected with this proposal? If yes, explain. **Not at this time.**

8. List any environmental information you know about that has been prepared, or will be prepared, directly related to this proposal. **None that I am aware of.**

9. Do you know whether applications are pending for governmental approvals of other proposals directly affecting the property covered by your proposal? If yes, explain. **No**

10. List any government approvals or permits that will be needed for your proposal, if known.

Fill and Grade permit ; Shoreline Substantial Development (mmp)

11. Give brief, complete description of your proposal, including the proposed uses and the size of the project and site. There are several questions later in this checklist that ask you to describe certain aspects of your proposal. You do not need to repeat those answers on this page. (Lead agencies may modify this form to include additional specific information on project description.)

The proposed improvements include an asphalt parking lot containing 91 parking stalls and two access locations to South Riverbend Rd, for a total amount of 34,187 square feet (0.785 Ac) of new, pollution generating impervious surfaces. The outbuilding proposed for future construction will create a total amount of 2,400 square feet (0.055 Ac) of new, non-pollution generating impervious surfaces. Altogether, the project proposes to create 36,587 square feet (0.840 Ac) of new impervious surfaces.

12. Location of the proposal. Give sufficient information for a person to understand the precise location of your proposed project, including a street address, if any, and section, township, and range, if known. If a proposal would occur over a range of area, provide the range or boundaries of the site(s). Provide a legal description, site plan, vicinity map, and topographic map, if reasonably available. While you should submit any plans required by the agency, you are not required to duplicate maps or detailed plans submitted with any permit applications related to this checklist.

The project site address is 315 Riverbend Road and is located west of the Interstate I-5 corridor, approximately 800 feet west of the intersection between South Riverbend Road and Freeway Drive in Mount Vernon, Washington. To the east is the open yard of Farrell's Auto Wrecking lot, to the north of the site are grass sports fields, bordering to the west is open agricultural land, and approximately 250 feet to the south across the road and undeveloped land is the main channel of the Skagit River.

Current Legal Description - P26202

TAX 64: PORTION GOVERNMENT LOT 7 BEGINNING AT A POINT ON N LINE OF COUNTY ROAD (DIKE 17) RUNNING ELY & WLY ACROSS SAID SUBDIVISION WHERE IT INTERSECTED BY W LINE SAID LOT 7 THEN ELY ALONG SAID N LINE OF ROAD 208.5 FEET THEN N PARALLEL TO W LINE SAID LOT 208.5 FEET THEN W PARALLEL TO SAID ROAD 208.5 FEET TO W LINE SAID LOT 7 THEN S ALONG SAID W LINE TO POINT OF BEGINNING

Current Legal Description - P26094

(1.9800 ac) DK 17: S1/2 NW1/4 SE1/4 & PTN GV LT 7 AKA TR D S/P MV #13-79 AF#7911160063

¼ Section	Section	Township	Range
SE	18	34 N	04 E

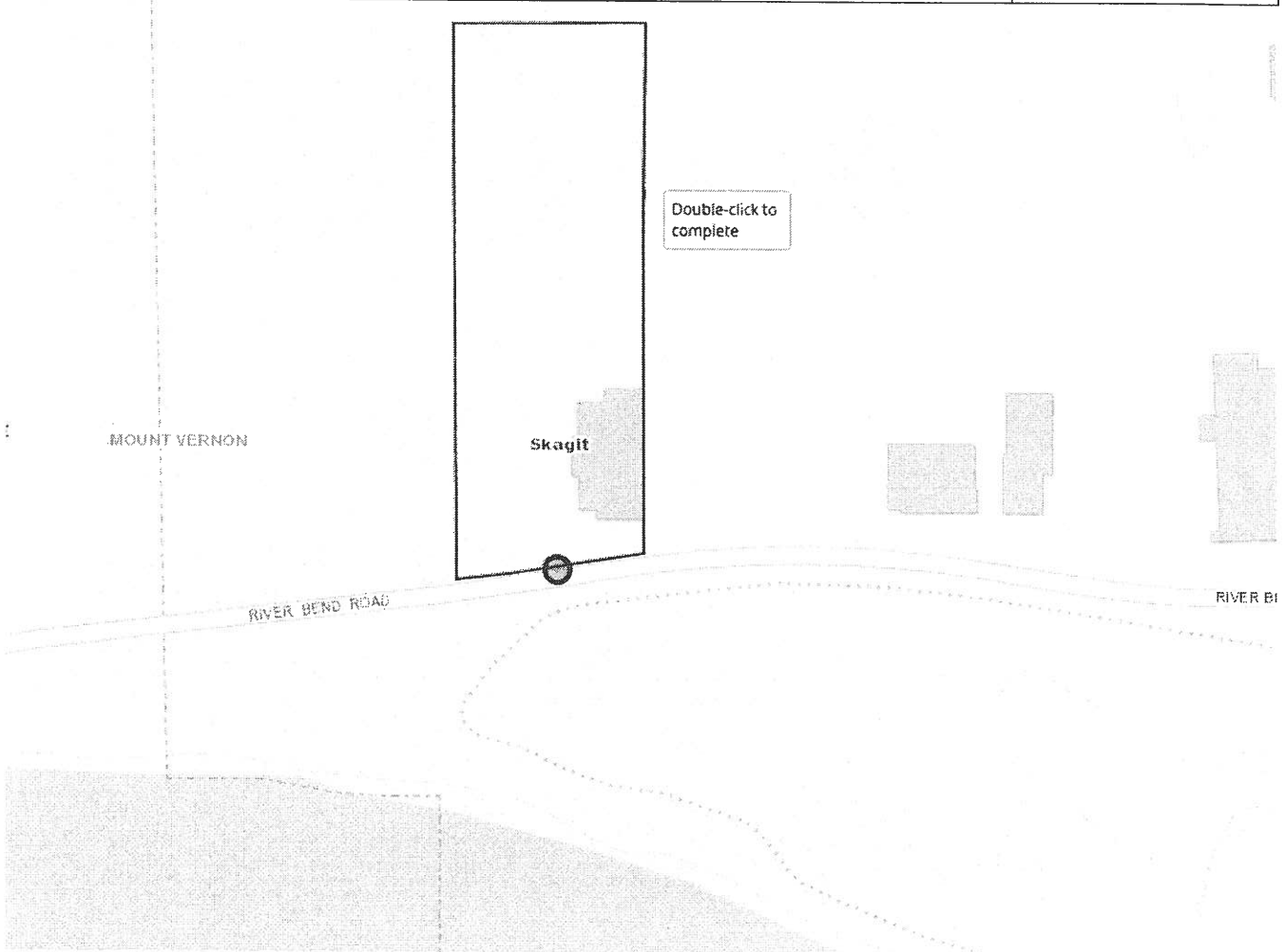

B. Environmental Elements [\[HELP\]](#)

1. **Earth** [\[help\]](#)

a. General description of the site:

(circle one): Flat, rolling, hilly, steep slopes, mountainous, other _____

b. What is the steepest slope on the site (approximate percent slope)?

The maximum slope is 2%.

c. What general types of soils are found on the site (for example, clay, sand, gravel, peat, muck)? If you know the classification of agricultural soils, specify them and note any agricultural land of long-term commercial significance and whether the proposal results in removing any of these soils.

Existing onsite soils consist of Existing Fills (Gravel with Sand), Silt (Silt with minor sand) underlain by Sandy Silt to Silty Sand.

d. Are there surface indications or history of unstable soils in the immediate vicinity? If so, describe. **No**

e. Describe the purpose, type, total area, and approximate quantities and total affected area of any filling, excavation, and grading proposed. Indicate source of fill.

The site will be re-graded to allow for drainage. Total disturbed area of 35,555 square feet. No off site export is proposed. Import of approximately 440 cubic yards of crushed rock. Re-grading will include approximately 400 cubic yards of material.

f. Could erosion occur as a result of clearing, construction, or use? If so, generally describe.

Minor erosion could possibly occur due to the flat nature of the site.

g. About what percent of the site will be covered with impervious surfaces after project construction (for example, asphalt or buildings)?

Approx 37% of the entire site will be impervious surfaces after project construction.

h. Proposed measures to reduce or control erosion, or other impacts to the earth, if any:

An erosion control and sedimentation plan consistent with the City's design standards will be developed for the site and will incorporate all appropriate best management practices to minimize the erosion potential.

2. Air [help]

a. What types of emissions to the air would result from the proposal during construction, operation, and maintenance when the project is completed? If any, generally describe and give approximate quantities if known.

Emissions normally associated with construction equipment will result from construction activity. Dust from construction activities may also occur, depending on weather and the moisture content of the soils.

No outdoor burning will take place. Clearing and grubbing debris will be chipped on site and the chips used for ground cover as part of the erosion and sedimentation control plan.

Construction of paved surfaces will produce some odors normally associated with construction of asphalt concrete pavements.

b. Are there any off-site sources of emissions or odor that may affect your proposal? If so, generally describe.

None

c. Proposed measures to reduce or control emissions or other impacts to air, if any:

Construction equipment will be maintained to appropriate levels to minimize emissions.

3. **Water** [help]

a. Surface Water: [help]

1) Is there any surface water body on or in the immediate vicinity of the site (including year-round and seasonal streams, saltwater, lakes, ponds, wetlands)? If yes, describe type and provide names. If appropriate, state what stream or river it flows into.

No ~~Yes~~ - the Skagit River is within ~~100~~ **250** feet of the site across River Bend Road as well as a dike. *The dike is within 200 feet. (m m a)*

2) Will the project require any work over, in, or adjacent to (within 200 feet) the described waters? If yes, please describe and attach available plans.

It appears that the edge of the Skagit River is 250 feet from the property boundary. The project will not require work over, in, or adjacent to the waters due to it being over 200 ft from the water edge.

3) Estimate the amount of fill and dredge material that would be placed in or removed from surface water or wetlands and indicate the area of the site that would be affected. Indicate the source of fill material.

Not Applicable

4) Will the proposal require surface water withdrawals or diversions? Give general description, purpose, and approximate quantities if known.

No

5) Does the proposal lie within a 100-year floodplain? If so, note location on the site plan.

Yes, the entire site is with the 100-year floodplain

6) Does the proposal involve any discharges of waste materials to surface waters? If so, describe the type of waste and anticipated volume of discharge.

No.

b. Ground Water: [help]

1) Will groundwater be withdrawn from a well for drinking water or other purposes? If so, give a general description of the well, proposed uses and approximate quantities withdrawn from the well. Will water be discharged to groundwater? Give general description, purpose, and approximate quantities if known.

The property is on public water from PUD. Surface water for the new parking surface is proposed to discharge to the ground and infiltrate on-site.

- 2) Describe waste material that will be discharged into the ground from septic tanks or other sources, if any (for example: Domestic sewage; industrial, containing the following chemicals. . . ; agricultural; etc.). Describe the general size of the system, the number of such systems, the number of houses to be served (if applicable), or the number of animals or humans the system(s) are expected to serve.

The site is serviced by public sewer.

c. Water runoff (including stormwater):

- 1) Describe the source of runoff (including storm water) and method of collection and disposal, if any (include quantities, if known). Where will this water flow? Will this water flow into other waters? If so, describe.

The surface runoff from the parking and existing roof discharge to the ground. The parking will collect the runoff in a swale and discharge to the ground by infiltration.

- 2) Could waste materials enter ground or surface waters? If so, generally describe.

The potential of this occurring is no more likely than in any location served by a public or private residential access street.

- 3) Does the proposal alter or otherwise affect drainage patterns in the vicinity of the site? If so, describe.

No, all existing drainage will infiltrate on-site because there are no surface drainage Ditches or Stormwater conveyance systems to directly tie into.

d. Proposed measures to reduce or control surface, ground, and runoff water, and drainage pattern impacts, if any:

All surface water is directed to the water quality swale and infiltration facility.

4. **Plants** [\[help\]](#)

a. Check the types of vegetation found on the site:

deciduous tree: alder, maple, aspen, other

evergreen tree: fir, cedar, pine, other

shrubs

grass

pasture

crop or grain

Orchards, vineyards or other permanent crops.

wet soil plants: cattail, buttercup, bullrush, skunk cabbage, other

water plants: water lily, eelgrass, milfoil, other

other types of vegetation

b. What kind and amount of vegetation will be removed or altered?

Some grass will be altered to provide for the infiltration swale.

- c. List threatened and endangered species known to be on or near the site.
None known.
- d. Proposed landscaping, use of native plants, or other measures to preserve or enhance vegetation on the site, if any:
The proposed infiltration swale will be landscaped with grass.
- e. List all noxious weeds and invasive species known to be on or near the site.
None known.

5. *Animals* [\[help\]](#)

- a. List any birds and other animals which have been observed on or near the site or are known to be on or near the site.

Examples include:

birds: **hawk, heron, eagle, songbirds**, other:
 mammals: deer, bear, elk, beaver, other:
 fish: bass, **salmon, trout**, herring, shellfish, other _____

- b. List any threatened and endangered species known to be on or near the site.
Bald eagle is listed as threatened.
- c. Is the site part of a migration route? If so, explain.
The site may lie within the Pacific Flyway.
- d. Proposed measures to preserve or enhance wildlife, if any:
None.
- e. List any invasive animal species known to be on or near the site.
None.

6. *Energy and Natural Resources* [\[help\]](#)

- a. What kinds of energy (electric, natural gas, oil, wood stove, solar) will be used to meet the completed project's energy needs? Describe whether it will be used for heating, manufacturing, etc.
Not applicable.
- b. Would your project affect the potential use of solar energy by adjacent properties? If so, generally describe.
Not applicable.
- c. What kinds of energy conservation features are included in the plans of this proposal? List other proposed measures to reduce or control energy impacts, if any:
Not applicable.

7. **Environmental Health** [\[help\]](#)

a. Are there any environmental health hazards, including exposure to toxic chemicals, risk of fire and explosion, spill, or hazardous waste, that could occur as a result of this proposal? If so, describe.

1) Describe any known or possible contamination at the site from present or past uses.

Not from current uses.

2) Describe existing hazardous chemicals/conditions that might affect project development and design. This includes underground hazardous liquid and gas transmission pipelines located within the project area and in the vicinity.

None.

3) Describe any toxic or hazardous chemicals that might be stored, used, or produced during the project's development or construction, or at any time during the operating life of the project.

None.

4) Describe special emergency services that might be required.

None.

5) Proposed measures to reduce or control environmental health hazards, if any:

None.

b. *Noise*

1) What types of noise exist in the area which may affect your project (for example: traffic, equipment, operation, other)?

The property is located in an industrial area with an auto-wrecking yard to the east, farmland to the west and a baseball field to the north. Riverbend Road and the Skagit River lie to the south. Most noise will be from the wrecking yard.

2) What types and levels of noise would be created by or associated with the project on a short-term or a long-term basis (for example: traffic, construction, operation, other)? Indicate what hours noise would come from the site.

This parking lot is for a church with minimal noise other than traffic. Construction noise would occur for a short-term duration in order to get the parking pavement down. Hours of construction could be from 7am – 10 pm as per City Ordinance.

3) Proposed measures to reduce or control noise impacts, if any:

None proposed.

8. **Land and Shoreline Use** [\[help\]](#)

- a. What is the current use of the site and adjacent properties? Will the proposal affect current land uses on nearby or adjacent properties? If so, describe.
There is no change in use of the property. It is currently a parking lot for the church and will stay the same.
- b. Has the project site been used as working farmlands or working forest lands? If so, describe. How much agricultural or forest land of long-term commercial significance will be converted to other uses as a result of the proposal, if any? If resource lands have not been designated, how many acres in farmland or forest land tax status will be converted to nonfarm or nonforest use?
No.
- 1) Will the proposal affect or be affected by surrounding working farm or forest land normal business operations, such as oversize equipment access, the application of pesticides, tilling, and harvesting? If so, how:
No.
- c. Describe any structures on the site.
There is a 7,900 square foot building on the site and a storage shed.
- d. Will any structures be demolished? If so, what?
No.
- e. What is the current zoning classification of the site?
Public District
- f. What is the current comprehensive plan designation of the site?
Church
- g. If applicable, what is the current shoreline master program designation of the site?
~~Not applicable~~ **Urban Mixed Use (MMA)**
- h. Has any part of the site been classified as a critical area by the city or county? If so, specify.
No.
- i. Approximately how many people would reside or work in the completed project?
2-3 people.
- j. Approximately how many people would the completed project displace?
None.
- k. Proposed measures to avoid or reduce displacement impacts, if any:
None.
- L. Proposed measures to ensure the proposal is compatible with existing and projected land uses and plans, if any: **Same use as before.**

- m. Proposed measures to reduce or control impacts to agricultural and forest lands of long-term commercial significance, if any:

Stormwater Runoff is proposed to infiltrate on-site as to not impact the nearby agricultural land.

9. Housing [help]

- a. Approximately how many units would be provided, if any? Indicate whether high, middle, or low-income housing.

Not applicable

- b. Approximately how many units, if any, would be eliminated? Indicate whether high, middle, or low-income housing.

Not applicable

- c. Proposed measures to reduce or control housing impacts, if any:

Not applicable

10. Aesthetics [help]

- a. What is the tallest height of any proposed structure(s), not including antennas; what is the principal exterior building material(s) proposed?

Not applicable

- b. What views in the immediate vicinity would be altered or obstructed?

None.

- b. Proposed measures to reduce or control aesthetic impacts, if any:

None.

11. Light and Glare [help]

- a. What type of light or glare will the proposal produce? What time of day would it mainly occur?

None.

- b. Could light or glare from the finished project be a safety hazard or interfere with views?

No

- c. What existing off-site sources of light or glare may affect your proposal?

No

- d. Proposed measures to reduce or control light and glare impacts, if any:

None.

12. Recreation [help]

- a. What designated and informal recreational opportunities are in the immediate vicinity?

There is a baseball field to the north on PUD property.

- b. Would the proposed project displace any existing recreational uses? If so, describe.
No.
- c. Proposed measures to reduce or control impacts on recreation, including recreation opportunities to be provided by the project or applicant, if any:
None.

13. Historic and cultural preservation [help]

- a. Are there any buildings, structures, or sites, located on or near the site that are over 45 years old listed in or eligible for listing in national, state, or local preservation registers? If so, specifically describe.
There are no buildings, structures or sites identified on the WISSARD at the DAHP web site in the vicinity of this project.
- b. Are there any landmarks, features, or other evidence of Indian or historic use or occupation? This may include human burials or old cemeteries. Are there any material evidence, artifacts, or areas of cultural importance on or near the site? Please list any professional studies conducted at the site to identify such resources.
This proposed paving project is over an existing gravel parking lot that has been in place for many years. The evidence is that the site was filled due to the grade difference with agricultural land to the west. No evidence to date show Indian or historic use or occupation.
- c. Describe the methods used to assess the potential impacts to cultural and historic resources on or near the project site. Examples include consultation with tribes and the department of archeology and historic preservation, archaeological surveys, historic maps, GIS data, etc.
None. Gretchen Kaehler from DAHP responded to an EZ1 request as follows "We have no archaeological resources recorded in the project area and no specific concerns. We would recommend an Inadvertent Discovery Plan."
- d. Proposed measures to avoid, minimize, or compensate for loss, changes to, and disturbance to resources. Please include plans for the above and any permits that may be required.
Should archaeological materials (e.g. bones, shell, stone tools, beads, ceramics, old bottles, hearths, etc.) or human remains be observed during project activities, all work in the immediate vicinity should stop. The State Department of Archaeology and Historic Preservation (360-586-3065), the County/City planning office, the affected Tribe(s) and the county coroner (if applicable) should be contacted immediately in order to help assess the situation and determine how to preserve the resource(s). Compliance with all applicable laws pertaining to archaeological resources (RCW 27.53, 27.44 and WAC 25-48) is required. Failure to comply with this requirement could constitute a Class C Felony.

14. Transportation [help]

- a. Identify public streets and highways serving the site or affected geographic area and describe proposed access to the existing street system. Show on site plans, if any.
Direct access is to River Bend Road which connects to Freeway Drive and Interstate 5.
- b. Is the site or affected geographic area currently served by public transit? If so, generally describe. If not, what is the approximate distance to the nearest transit stop?
Public transit is available on Freeway Drive 900 feet to the east.

- c. How many additional parking spaces would the completed project or non-project proposal have? How many would the project or proposal eliminate?

The number of parking stalls will not change from the number of parking stalls that currently exist.

- d. Will the proposal require any new or improvements to existing roads, streets, pedestrian, bicycle or state transportation facilities, not including driveways? If so, generally describe (indicate whether public or private).

No.

- e. Will the project or proposal use (or occur in the immediate vicinity of) water, rail, or air transportation? If so, generally describe.

No.

- f. How many vehicular trips per day would be generated by the completed project or proposal? If known, indicate when peak volumes would occur and what percentage of the volume would be trucks (such as commercial and nonpassenger vehicles). What data or transportation models were used to make these estimates?

The church lot will be primarily used on Sundays with maximum traffic. Daily traffic will be 3 to 20 vehicular trips depending on the activity most of which are short term of an hour or two. Minimal truck use.

- g. Will the proposal interfere with, affect or be affected by the movement of agricultural and forest products on roads or streets in the area? If so, generally describe.

No.

- h. Proposed measures to reduce or control transportation impacts, if any:

No.

15. Public Services [\[help\]](#)

- a. Would the project result in an increased need for public services (for example: fire protection, police protection, public transit, health care, schools, other)? If so, generally describe.

None that are not already in use.

- b. Proposed measures to reduce or control direct impacts on public services, if any.

None.

16. Utilities [\[help\]](#)

- a. Circle utilities currently available at the site:

electricity, natural gas, water, refuse service, telephone, sanitary sewer, septic system, other _____

- c. Describe the utilities that are proposed for the project, the utility providing the service, and the general construction activities on the site or in the immediate vicinity which might be needed.

An 8" storm drainage pipe, a Stormwater Bioretention treatment and infiltration cell, and a

Stormwater Infiltration Pond will be provided by the owner/contractor and are the only stormwater utilities proposed.

C. Signature [HELP]

The above answers are true and complete to the best of my knowledge. I understand that the lead agency is relying on them to make its decision.

Signature: Igor Kaparchuk.....

Name of signee: Igor Kaparchuk.....

Position and Agency/Organization: Project Coordinator – New Life Christian Church

Date Submitted: 09/04/2018

Edited 9/27/2018 MMA

D. Supplemental sheet for nonproject actions [HELP]

(IT IS NOT NECESSARY to use this sheet for project actions)

Because these questions are very general, it may be helpful to read them in conjunction with the list of the elements of the environment.

When answering these questions, be aware of the extent the proposal, or the types of activities likely to result from the proposal, would affect the item at a greater intensity or at a faster rate than if the proposal were not implemented. Respond briefly and in general terms.

1. How would the proposal be likely to increase discharge to water; emissions to air; production, storage, or release of toxic or hazardous substances; or production of noise?

Proposed measures to avoid or reduce such increases are:

2. How would the proposal be likely to affect plants, animals, fish, or marine life?

Proposed measures to protect or conserve plants, animals, fish, or marine life are:

3. How would the proposal be likely to deplete energy or natural resources?

Proposed measures to protect or conserve energy and natural resources are:

4. How would the proposal be likely to use or affect environmentally sensitive areas or areas designated (or eligible or under study) for governmental protection; such as parks, wilderness, wild and scenic rivers, threatened or endangered species habitat, historic or cultural sites, wetlands, floodplains, or prime farmlands?

Proposed measures to protect such resources or to avoid or reduce impacts are:

5. How would the proposal be likely to affect land and shoreline use, including whether it would allow or encourage land or shoreline uses incompatible with existing plans?

Proposed measures to avoid or reduce shoreline and land use impacts are:

6. How would the proposal be likely to increase demands on transportation or public services and utilities?

Proposed measures to reduce or respond to such demand(s) are:

7. Identify, if possible, whether the proposal may conflict with local, state, or federal laws or requirements for the protection of the environment.